



CONTINUOUS 350 kVA

50 Hz

Caterpillar is leading the power generation marketplace with Power Solutions engineered to deliver unmatched flexibility, expandability, reliability, and cost-effectiveness.

FEATURES

FULL RANGE OF ATTACHMENTS

- Wide range of bolt-on system expansion attachments, factory designed and tested

SINGLE-SOURCE SUPPLIER

- **Fully Prototype Tested** with certified torsional vibration analysis available

WORLDWIDE PRODUCT SUPPORT

- Worldwide parts availability through the Caterpillar dealer network
- With over 1,200 dealer outlets operating in 166 countries, you're never far from the Caterpillar part you need.
- 99.5% of parts orders filled within 48 hours. The best product support record in the industry.
- Caterpillar dealer service technicians are trained to service every aspect of your electric power generation system.
- Preventive maintenance agreements
- The Cat Scheduled Oil Sampling (S•O•SSM) program cost effectively detects internal engine component condition, even the presence of unwanted fluids and combustion by-products



CAT® G3412 TA GAS ENGINE

- Reliable, rugged, durable design
- Field-proven in thousands of applications worldwide
- Low pressure gas



CAT SR4B GENERATOR

- Designed to match performance and output characteristics of Caterpillar engines
- Optimum winding pitch for minimum total harmonic distortion and maximum efficiency
- Segregated AC/DC, low voltage accessory box provides single point access to accessory connections



CAT CONTROL PANELS

- Two levels of controls, designed to meet individual customer needs:
 - EMCP II provides digital monitoring, metering, and protection
 - EMCP II+ provides EMCP II features along with full-featured power metering and protective relaying

 **TECHNICAL DATA**

Open Generator Set — 1500 rpm/50 Hz/400 Volts		Continuous DM5449
Package Performance		
Power rating @ 0.8 PF	kVA	350
Power rating	kW	280
Aftercooler temperature	Deg C	54
Fuel Consumption		
100% load with fan	N•m ³ /hr	97
75% load with fan	N•m ³ /hr	78
50% load with fan	N•m ³ /hr	59
Cooling System		
Ambient air temperature*	Deg C	40
Air flow restriction (system)	kPa	0.12
Air flow (maximum @ rated speed for standard radiator arrangement)	m ³ /min	990
Engine coolant capacity with radiator	L	106
Jacket water outlet temperature	Deg C	99
Exhaust System		
Combustion air inlet flow rate	N•m ³ /min	19
Exhaust gas stack temperature	Deg C	454
Exhaust gas flow rate	N•m ³ /min	20
Exhaust flange size (internal diameter)	mm	203
Exhaust system backpressure (maximum allowable)	kPa	6.7
Heat Rejection		
Low Heat Value (LHV) fuel input	kW	976
Heat rejection to jacket water (includes oil cooler)	kW	360
Total heat rejection to exhaust (LHV to 25° C)	kW	214
Heat rejection to exhaust (LHV to 120° C)	kW	161
Heat rejection to A/C	kW	10
Heat rejection to atmosphere from engine	kW	39
Heat rejection to atmosphere from generator	kW	25
Generator		
Motor starting capability @ 30% voltage dip	kVA	724
Frame		592
Temperature rise	Deg C	105
 Emissions**		
NOx	mg/N•m ³ @ 5% O ₂	10 704
CO	mg/N•m ³ @ 5% O ₂	690
HC (total)	mg/N•m ³ @ 5% O ₂	865
HC (non-methane)	mg/N•m ³ @ 5% O ₂	130
Exhaust O ₂ (dry)	%	4.0

*Ambient capability at 200 m (660 ft) above sea level. For ambient capability at other altitudes, consult your Caterpillar dealer.

**Assumes synchronous driver

***Emissions data measurement is consistent with those described in EPA CFR 40 PART 89 SUBPART D and ISO 8178-1 for measuring HC, CO, CO₂ and NOx. Data shown is based on steady state engine operating conditions of 77° F, 28.43 inches HG and fuel having a LHV of 920 BTU per cubic foot at 30.00 inches HG absolute and 32° F. Not to exceed emission data shown is subject to instrumentation, measurement, facility and engine fuel system adjustments.

RATING DEFINITIONS AND CONDITIONS

Continuous — Output available without varying load for an unlimited time.

Ratings are based on ISO3046/1 standard reference conditions of 25° C (77° F) and 100 kPa (29.61 in Hg).

Ratings are based on pipeline natural gas having a LHV (low heat value) of 36.2 mJ/N•m³ (920 Btu/cu ft). Variations in altitude, temperature, and gas composition from standard conditions or the use of a three way catalyst may require a reduction in engine horsepower.

CONTINUOUS POWER GENERATOR SET PACKAGE — TOP VIEW

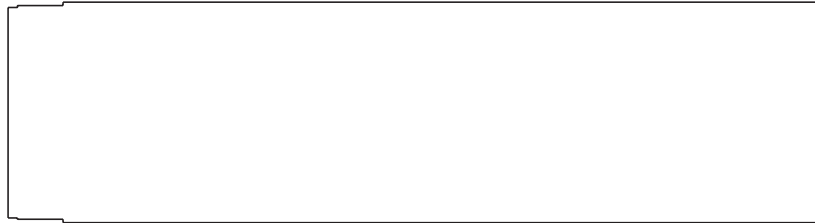

CONTINUOUS POWER GENERATOR SET PACKAGE — SIDE VIEW

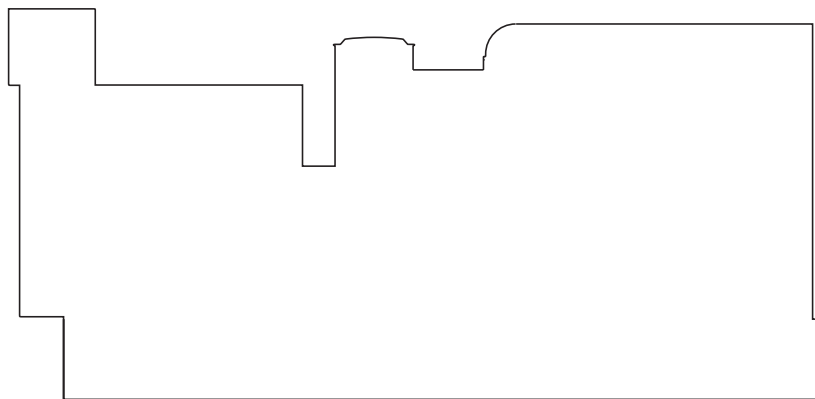

Package Dimensions		
Length	4543.1 mm	178.86 in
Width	2235.8 mm	88.02 in
Height	2466.4 mm	97.10 in
Shipping Weight	6356 kg	14,000 lb

Note: Do not use for installation design.
See general dimension drawings
for detail (Drawing #207-4502).