

CONTINUOUS 200 kVA

50 Hz

Caterpillar is leading the power generation marketplace with Power Solutions engineered to deliver unmatched flexibility, expandability, reliability, and cost-effectiveness.

FEATURES

FULL RANGE OF ATTACHMENTS

- Wide range of bolt-on system expansion attachments, factory designed and tested

SINGLE-SOURCE SUPPLIER

- **Fully Prototype Tested** with certified torsional vibration analysis available

WORLDWIDE PRODUCT SUPPORT

- Worldwide parts availability through the Caterpillar dealer network
- With over 1,200 dealer outlets operating in 166 countries, you're never far from the Caterpillar part you need.
- 99.5% of parts orders filled within 48 hours. The best product support record in the industry.
- Caterpillar dealer service technicians are trained to service every aspect of your electric power generation system.
- Preventive maintenance agreements
- The Cat Scheduled Oil Sampling (S·O·SSM) program cost effectively detects internal engine component condition, even the presence of unwanted fluids and combustion by-products



CAT® G3406 TA GAS ENGINE

- Reliable, rugged, durable design
- Field-proven in thousands of applications worldwide
- Low pressure gas



CAT SR4B GENERATOR

- Designed to match performance and output characteristics of Caterpillar engines
- Optimum winding pitch for minimum total harmonic distortion and maximum efficiency
- Segregated AC/DC, low voltage accessory box provides single point access to accessory connections



CAT CONTROL PANELS

- Two levels of controls, designed to meet individual customer needs:
 - EMCP II provides digital monitoring, metering, and protection
 - EMCP II+ provides EMCP II features along with full-featured power metering and protective relaying

 **TECHNICAL DATA**

Open Generator Set — 1500 rpm/50 Hz/400 Volts		Continuous DM5448
Package Performance Power rating @ 0.8 PF Power rating Aftercooler temperature	kVA ekW Deg C	200 160 54
Fuel Consumption 100% load with fan 75% load with fan 50% load with fan	N·m ³ /hr N·m ³ /hr N·m ³ /hr	52 41 30
Cooling System Ambient air temperature* Air flow restriction (system) Air flow (maximum @ rated speed for standard radiator arrangement) Engine coolant capacity with radiator Jacket water outlet temperature	Deg C kPa m ³ /min L Deg C	40 0.12 662 57 99
Exhaust System Combustion air inlet flow rate Exhaust gas stack temperature Exhaust gas flow rate Exhaust flange size (internal diameter) Exhaust system backpressure (maximum allowable)	N·m ³ /min Deg C N·m ³ /min mm kPa	10 488 11 127 6.7
Heat Rejection Low Heat Value (LHV) fuel input Heat rejection to jacket water (includes oil cooler) Total heat rejection to exhaust (LHV to 25° C) Heat rejection to exhaust (LHV to 120° C) Heat rejection to A/C Heat rejection to atmosphere from engine Heat rejection to atmosphere from generator	kW kW kW kW kW kW kW	524 174 134 97 6 21 13
Generator Motor starting capability @ 30% voltage dip** Frame Temperature rise	kVA Deg C	506 447 105
 Emissions*** NOx CO HC (total) HC (non-methane) Exhaust O ₂ (dry)	mg/N·m ³ @ 5% O ₂ mg/N·m ³ @ 5% O ₂ mg/N·m ³ @ 5% O ₂ mg/N·m ³ @ 5% O ₂ %	8167 532 2036 306 4.0

*Ambient capability at 200 m (660 ft) above sea level. For ambient capability at other altitudes, consult your Caterpillar dealer.

**Assumes synchronous driver

***Emissions data measurement is consistent with those described in EPA CFR 40 PART 89 SUBPART D and ISO 8178-1 for measuring HC, CO, CO₂ and NOx. Data shown is based on steady state engine operating conditions of 77° F, 28.43 inches HG and fuel having a LHV of 920 BTU per cubic foot at 30.00 inches HG absolute and 32° F. Not to exceed emission data shown is subject to instrumentation, measurement, facility and engine fuel system adjustments.

RATING DEFINITIONS AND CONDITIONS

Continuous — Output available without varying load for an unlimited time.

Ratings are based on ISO3046/1 standard reference conditions of 25° C (77° F) and 100 kPa (29.61 in Hg).

Ratings are based on pipeline natural gas having a LHV (low heat value) of 36.2 mJ/N·m³ (920 Btu/cu ft). Variations in altitude, temperature, and gas composition from standard conditions or the use of a three way catalyst may require a reduction in engine horsepower.

CONTINUOUS POWER GENERATOR SET PACKAGE — TOP VIEW

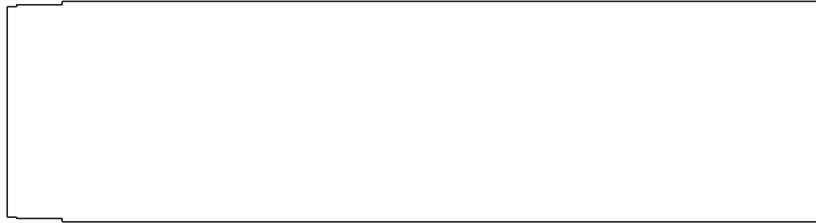

CONTINUOUS POWER GENERATOR SET PACKAGE — SIDE VIEW

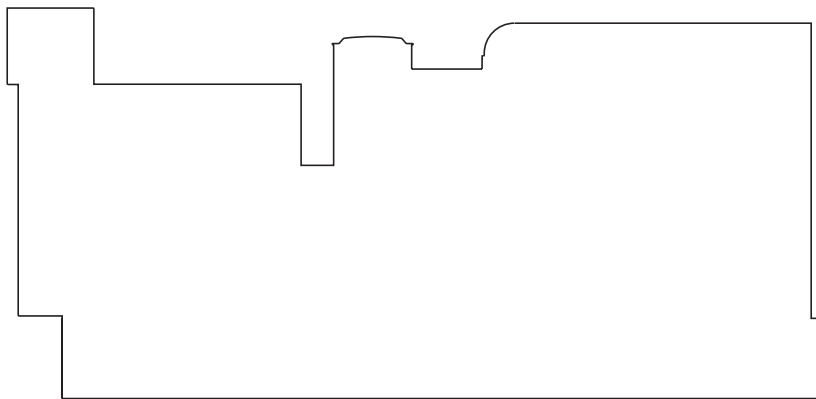

Package Dimensions		
Length	4074 mm	160.39 in
Width	1398.4 mm	55.05 in
Height	2138.6 mm	84.20 in
Shipping Weight	4318 kg	9500 lb

Note: Do not use for installation design.
See general dimension drawings
for detail (Drawing #205-4501).