

Grapple Buckets, Forks and Rakes

for Skid Steer, Multi Terrain and Compact Track Loaders



Cat® industrial grapple buckets, rakes and forks are designed to easily handle a wide array of bulky, irregularly shaped objects encountered in demolition, industrial, construction, recycling, storm debris clean-up, landscaping and other aggressive applications.

Features

- Two top grapple clamps operate independently
- Top clamps operate over an arc of 90 degrees
- Deep flat floor/fork construction
- Different width available
- Constructive design profile (bucket and fork)

Benefits

- Provides the ability to clamp and retain differential loads, e.g. paper, plastic, tyres, greenwaste, bales, etc.
- Improved loadability ensuring maximum capacity.
- High rated capacity, increasing productivity.
- Matched capacity to application, delivering efficiency.
- Enhanced performance.

Grapple Buckets, Forks and Rakes

for Skid Steer and Multi Terrain Loaders



Utility Grapple Buckets and Forks.

Designed to handle light, hard to handle materials encountered on a farm, ranch or landscaping project. Grasping materials such as loose hay, straw, bedding materials, dry compacted livestock waste, landscaping mulch and pine straw.

Industrial Grapple Buckets.

Ideal for grasping objects such as railroad ties, trees, large rocks, brush, industrial and demolition scrap, and recycling debris. For demolition, industrial, construction, recycling and other aggressive applications.

Industrial Grapple Forks.

Piercing and grasping paper, cardboard, wood and light gauge metal scrap. For demolition, industrial, construction, recycling and other aggressive applications.

Industrial Grapple Rakes

Ideal for storm debris clean-up and land clearing applications due to their open floor design which allows unwanted material to filter out through the tines while the grapples clamp firmly on the debris.

Specifications and Dimensions

Industrial Bucket

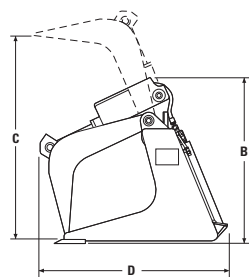
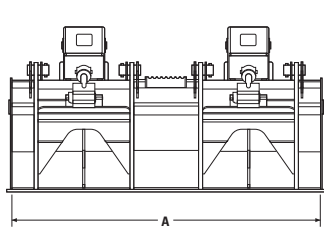

Utility Bucket

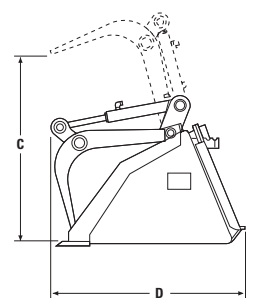
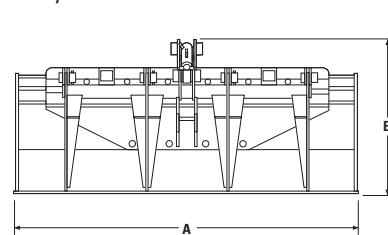

Grapple Buckets

		Industrial			Utility	
A Width*	mm	1524	1676	1830	1676	1830
B Height, Grapples Closed	mm	813	813	813	739	739
C Jaw Opening	mm	1016	1016	1016	902	902
D Length	mm	940	940	940	934	934
Bucket Weight**	kg	435	448	462	354	372
Sidewall Thickness	mm	10	10	10	—	—
Base Edge Thickness	mm	19	19	19	19	19
Cutting Edge Thickness***	mm	16	16	16	16	16

Specifications and Dimensions

Industrial Fork

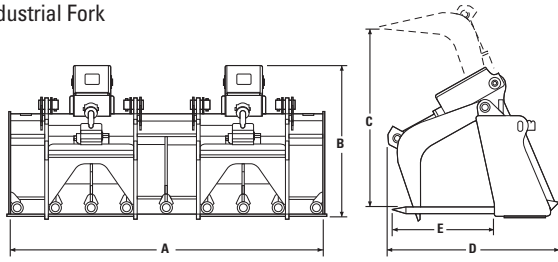

Utility Fork

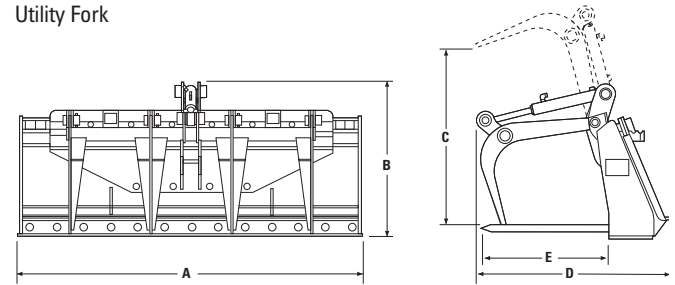

Grapple Forks

		Industrial		Utility	
A Width*	mm	1676	1830	1676	1830
B Height, Grapples Closed	mm	813	813	755	755
C Jaw Opening	mm	965	965	876	876
D Length	mm	940	940	940	940
E Exposed Tine Length	mm	559	559	627	627
Weight	kg	485	533	195	227
Tine Diameter	mm	43	43	32	32
Number of Tines		9	11	7	9
Total Fork Tine Holes		13	17		

Industrial Rake

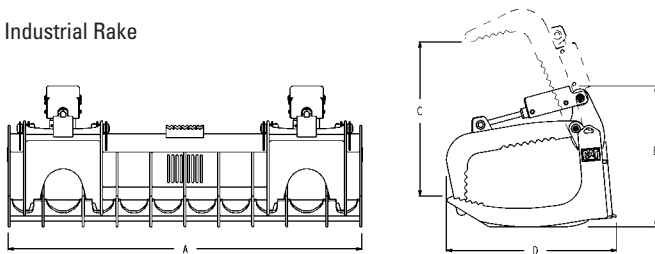

Grapple Rakes

		Industrial	
A Width*	mm	1829	2134
B Height,	mm	838	838
C Jaw Opening	mm	940	940
D Length	mm	1016	1016
Weight	kg	467	515
Number of Tines		9	11

* Measured from inside of side plate to inside of side plate; overall width is approximately 50 mm wider.

** With base cutting edge only, without ground engaging tools.

*** Optional bolt-on cutting edge.

Grapple Buckets, Forks and Rakes

Hydraulic Requirements

Standard flow hydraulics and no electrics.

Matching Guide

	Skid Steer Loaders	Multi Terrain Loaders	Compact Track Loaders
Industrial/Utility Grapple Buckets			
1524/1676 mm	216B, 226B, 232B, 236B, 242B, 247B, 252B, 257B, 246C, 256C, 262C, 272C, 277C, 287C, 297C, 279C, 289C, 299C	247B, 257B	279C, 289C, 299C
1830 mm	216B, 226B, 232B, 236B, 242B, 247B, 252B, 257B, 246C, 256C, 262C, 272C, 277C, 287C, 297C, 279C, 289C, 299C	247B, 257B, 277C, 287C, 297C	279C, 289C, 299C
Industrial/Utility Grapple Forks			
1676 mm	216B, 226B, 232B, 236B, 242B, 247B, 252B, 257B, 246C, 256C, 262C, 272C, 277C, 287C, 297C, 279C, 289C, 299C	247B, 257B	279C, 289C, 299C
1830 mm	216B, 226B, 232B, 236B, 242B, 247B, 252B, 257B, 246C, 256C, 262C, 272C, 277C, 287C, 297C, 279C, 289C, 299C	247B, 257B, 277C, 287C, 297C	279C, 289C, 299C
Industrial Grapple Rake			
1830 mm	216B, 226B, 232B, 236B, 242B, 247B, 252B, 257B, 246C, 256C, 262C, 272C, 277C, 287C, 297C, 279C, 289C, 299C	247B, 257B, 277C, 287C, 297C	279C, 289C, 299C
2134 mm	216B, 226B, 232B, 236B, 242B, 247B, 252B, 257B, 246C, 256C, 262C, 272C, 277C, 287C, 297C, 279C, 289C, 299C	277C, 287C, 297C	279C, 289C, 299C

For more complete information on Cat products, dealer services, and industry solutions, visit us on the web at www.cat.com

HEHX3179-4 (10/2008) hr

© 2008 Caterpillar -- All Rights Reserved

Materials and specifications are subject to change without notice. Featured machines in photos may include additional equipment. See your Caterpillar dealer for available options.

CAT, CATERPILLAR, their respective logos, "Caterpillar Yellow" and the POWER EDGE™ trade dress, as well as corporate and product identity used herein, are trademarks of Caterpillar and may not be used without permission.

CATERPILLAR®
TODAY'S WORK. TOMORROW'S WORLD.™