



H45, H45s, H55Ds, H65Ds

Hydraulic Hammers for Skid Steer and Multi Terrain Loaders

Features

- High blow rate
- Constant blow energy
- Slip fit lower tool bushing
- High pressure accumulator
- Single bushing design (H55Ds and H65Ds)

Benefits

- Very high blow rate means very high productivity for all hammers.
- Maximum and constant blow energy regardless of the oil flow adjustment (within the given min and max oil flow specifications).
- Slip fit field serviceable lower tool bushing with internal dust seal. Bushing includes grease retention grooves for better lubrication.
- A high-pressure accumulator located on the back side of the hammer protects the carrier pumps from hydraulic pressure spikes.
- Combined three bushings into one (upper, lower and thrust ring), slip fit and field replaceable.

Hydraulic Hammers for SSL and MTL

- 1 **Low Pressure Accumulator** – Assists in the power stroke of the piston.
- 2 **Custom Sideplates** – Designed for Caterpillar carrier geometry. Protects the powercell and front end.
- 3 **High Pressure Accumulator** – Dampens pressure peaks thus protecting the carrier hydraulic system (not shown).
- 4 **Distributor** – High oil volume for greater blow frequency.
- 5 **Pressure Adjusting Valve (PAV)** – Assures that all blows are delivered at a constant blow energy.
- 6 **Piston** – Long heavy piston delivers maximum impact energy and minimizes recoil forces to carrier.
- 7 **Long Front End** – Ensures proper piston tool alignment.
- 8 **Slip Fit Thrust Ring** – Dissipates harmful shock loads in abusive applications.
- 9 **Slip Fit Upper Tool Bushing** – Positive alignment for the tool.
- 10 **Tool Retention Pin System** – Allows quick and easy removal of tool.
- 11 **Side Plate Fastener** – Working forces carried through cap screws and front end.
- 12 **Slip Fit Lower Tool Bushing (Field Replaceable)** – Grease retention grooves for extended lubrication and wear indication.
- 13 **Dust Seal** – Dust Seal helps prevent foreign material from entering the housing. This reduces the wear on the power cell and other major components.
- 14 **Tool** – Heat treated for longer life. Ideally matched to piston for greater transfer of stress waves.

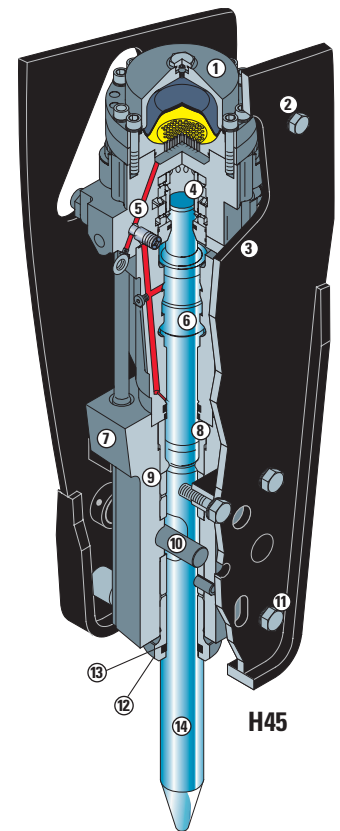

- 1 **Integral Mounting Arrangement** – eliminates the need for additional mounting bracket when installing hammer onto Caterpillar machines. Hammer comes with mounting configuration.
- 2 **2-Position Hose Mounting** – optimized hose routing for each installation, protecting hoses from damage and wear.
- 3 **One Piece Body** – reduced hammer components minimize service time required.
- 4 **Inlet (HP) Surge Accumulator** – protects host machine from hydraulic pulsations, improving hydraulic component life.
- 5 **Tubular Accumulator** – eliminates accumulator retention screws, improves hammer efficiency while simplifying maintenance.
- 6 **Distributor** – high oil volume for greater blow frequency.
- 7 **Pressure Adjusting Valve (PAV)** – assures that all blows are delivered at a constant blow energy.
- 8 **Piston** – long heavy piston delivers maximum impact energy and minimizes recoil forces to carrier.
- 9 **Replaceable Piston Sleeve** – reduces the cost to repair in event of catastrophic failure, simplifies serviceability.
- 10 **Shock Isolation** – significantly reduces shock loads transferred to the machine during hammer operation, to improve operator comfort and extend life of critical machine components.
- 11 **Round Tool Retaining Pin with Locking Mechanism** – no loose parts when changing tool.
- 12 **Single Piece Upper & Lower Tool Bushing with Integral Tool Stop** – simplifies product maintenance by allowing field replacement of all tool wear components.
- 13 **Dust Seal** – helps prevent foreign material from entering the housing, which reduces the wear on the power cell and other major components.
- 14 **Tool** – heat treated for longer life, ideally matched to piston for greater transfer of stress waves.
- 15 **Enclosed Housing** – provides protection to the power cell and provides noise reduction.

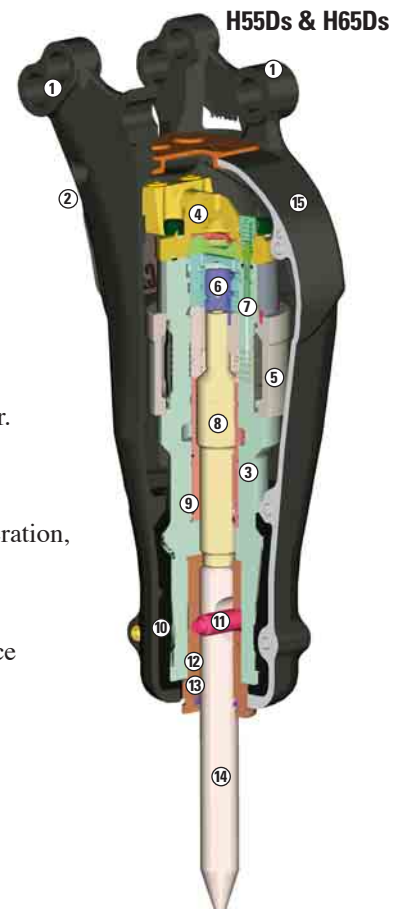

Applications Guide with Standard Tools



Chisel

Applications

- Sedimentary and weak metamorphic rock into which tool penetrates
- Concrete

C

Select when:

- Working in non-abrasive but ductile rock
- Needing medium penetration rate into rock



Moil

Applications

- Sedimentary and weak metamorphic rock into which tool penetrates
- Concrete

M

Select when:

- Working in soft, non-abrasive rock
- Needing greater protection against excessive retaining pin groove wear



Spade (parallel or transverse)

Applications

- Frozen or compact ground
- Asphalt

S

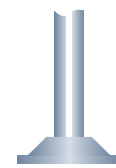

Compacting Plate

Applications

- Ground compacting

CP

C Chisel
M Moil
S Spade
CP Compacting Plate

Roadbuilding/construction

	H45/H45s	H55Ds	H65Ds
Breaking of road surface (concrete, asphalt)	S	S	S
Asphalt cutting to shape or area	S	S	S
Compacting the ground	CP	CP	CP
Breaking of frozen ground		C, S	C, S

Demolition/housing development

Demolition of concrete walls, roofs, floors	C, M	C, M	C, M
Demolition of light, reinforced concrete foundation	C, M	C, M	C, M
Brick walls	C, M	C, M	C, M
Breaking of frozen ground	C, M	C, M	C, M

Metallurgical applications

Breaking of slag in casting ladles		C, M	C, M
Breaking of refractory linings in furnaces	C, M	C, M	C, M

Specifications

		H45/H45s	H55Ds	H65Ds
Recommended carrier weight	tonnes	1.3-3.2	2.5-4.5	3.0-6.5
Working weight*	kg	130/140	199	271
Impact frequency	bpm	830-2500	1022-2300	700-2000
Acceptable oil flow	liter/min	20-50	40-85	40-105
Operating pressure	bar	140	170	170

* Working weight includes hammer, standard tool and average mounting bracket.



H45, H45s, H55Ds, H65Ds Hydraulic Hammers

Dimensions

		H45/H45s	H55Ds	H65Ds
A	mm	340		
	mm	440	429	454
B	mm	280		
	mm	280	300	300
C	mm	775		
	mm	775	997	1055
D	mm	45		
	mm	45	56	65
E	mm	262		
	mm	249	299	330

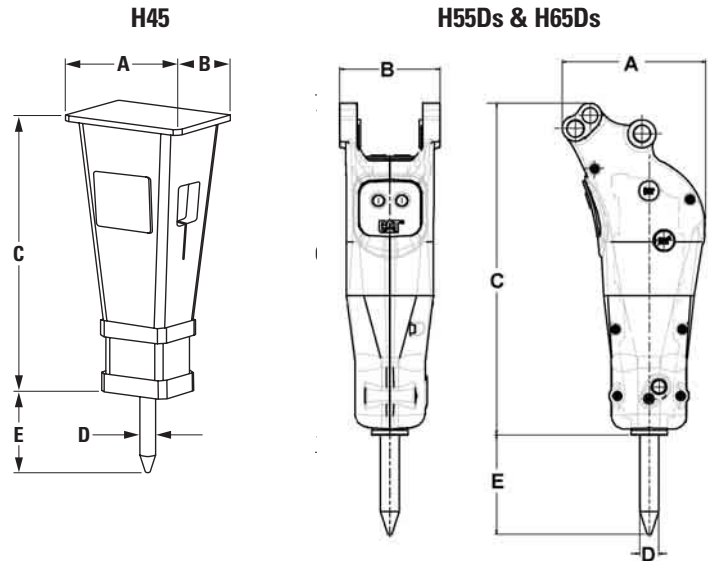

Hydraulic Requirements

Auxiliary hydraulic as standard in machine.

Matching Guide

Hammer	Skid Steer Loaders*	Multi Terrain Loaders
H45/H45s	216B, 226B, 232B**	
H55Ds	216B, 226B, 232B, 236B, 242B, 246B, 248B, 252B, 262B, 268B	247B, 257B, 267B, 277B, 287B
H65Ds	216B, 226B, 232B, 236B, 242B, 246B, 248B, 252B, 262B, 268B	247B, 257B, 267B, 277B, 287B

* SSL with BH150 or BH160 match hammers to SSL as per above.

**Special configuration – only applicable when machine is fitted with backhoe attachment BH27.