

H35D S, H45D S, H55D S, H65D S

Hydraulic Hammers for Mini Excavators



Features

High Oil Flow Acceptance

Less Parts

6-Piece Isolation System

Silenced as Standard

Benefits

The hammer has a high frequency and high productivity to get the job done fast. Due to the wide oil flow acceptance range, the hammer can be used across a wide range of carrier brands for maximum utilization within a mixed carrier fleet.

Owning and operating costs are minimized. Wear parts are field replaceable without the need for special tools thus minimizing downtime and increasing up time and productivity.

Isolates vibration transmitted to the carrier via stick and boom for machine protection and operator comfort.

For operation in residential and noise-sensitive applications where compliance with regulations must be met.

CATERPILLAR®

Hydraulic Hammers for Mini Excavators

- 1 Integral Mounting Arrangement (H55D S Pin-On / H65D S Pin-On)** – optimum compatibility with Cat Mini-Excavators. Compatible with Caterpillar pin grabber quick coupler system.
- 2 Flat Top Mounting (H35D S / H45D S / H55D S / H65D S)** – design to accommodate brackets and dedicated quick couplers.
- 3 One Piece Body** – reduces components and eliminates tie rods and nuts.
- 4 Low Pressure Tubular Accumulator** – assists in the power stroke of the piston.
- 5 Distributor** – high oil volume for greater blow frequency.
- 6 Pressure Adjusting Valve (PAV)** – assures that all blows are delivered at a constant blow energy.
- 7 Piston** – long heavy piston delivers maximum impact energy and minimizes recoil forces to carrier.
- 8 Cylinder Sleeve** – provides replaceable and economical protection for the cylinder.
- 9 6-Piece Isolation System** – significantly reduces shock loads transferred to the machine during hammer operation, to improve operator comfort and extend life of critical machine components.
- 10 Round Tool Retaining Pin** – simple design allows for rapid tool and bushing removal and replacement.
- 11 Single Bushing Design** – slip fit field replaceable one piece bushing (includes lower, upper and thrust ring)..
- 12 Bushing Dust Seal** – prevents contamination of grease and extends life of wear components.
- 13 Tool** – heat treated for longer life, ideally matched to piston for greater transfer of energy.
- 14 Enclosed Housing with Dampers** – provides protection to the power cell and provides noise reduction.

H35D S, H45D S, H55D S, H65D S
Flat-Top

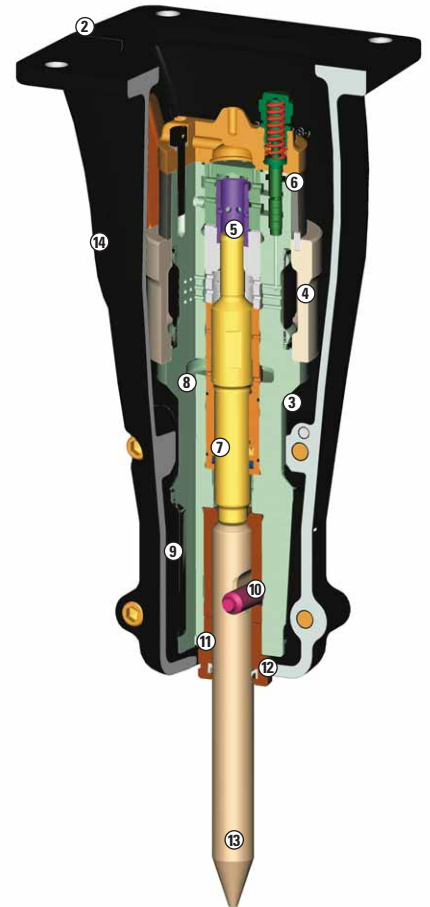

H55D S, H65D S
Pin-On



Applications Guide with Standard Tools



Chisel

Applications

- Sedimentary and weak metamorphic rock into which tool penetrates
- Concrete

C

Select when:

- Working in non-abrasive but ductile rock
- Needing medium penetration rate into rock



Moil

Applications

- Sedimentary and weak metamorphic rock into which tool penetrates
- Concrete

M

Select when:

- Working in soft, non-abrasive rock
- Needing greater protection against excessive retaining pin groove wear



Spade (parallel or transverse)

Applications

- Frozen or compact ground
- Asphalt

S

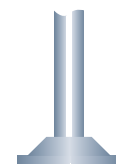

Compacting Plate

Applications

- Ground compacting

CP

C Chisel
M Moil
S Spade
CP Compacting Plate

Roadbuilding/construction

	H35D S	H45D S	H55D S	H65D S
Breaking of road surface	C, M, S	C, M, S	C, M, S	C, M, S
Asphalt cutting to shape or area	C, S	C, S	C, S	C, S
Demolition of bridges	C, M	C, M	C, M	C, M
Compacting soils	CP	CP	CP	CP
Making holes (for traffic signs, lamp posts)	M	M	M	M
Breaking of frozen ground	C, M, S	C, M, S	C, M, S	C, M, S

Demolition/housing development

Demolition of concrete walls, roofs, floors	C, M	C, M	C, M	C, M
Demolition of light, reinforced concrete foundation (<.5 m)	M	M	M	M
Brick walls	C, M	C, M	C, M	C, M
Separating rebar from concrete (for recycling)	C, M	C, M	C, M	C, M

Metallurgical applications

Breaking of refractory linings in furnaces	C, M	C, M	C, M	C, M
--	------	------	------	------

Specifications

		H35D S	H45D S	H55D S Flat-top	H55D S Pin-On	H65D S Flat-top	H65D S Pin-On
Recommended carrier weight	tonnes	1.1-2.4	1.5-3.2	2.5-6.0	2.5-5.2	4.5-9.0	3.0-6.5
Working weight*	kg	103	145	250	199	385	271
Impact frequency	bpm	800-2900	900-2500	1022-2300	1022-2300	700-2000	700-2000
Acceptable oil flow	liter/min	12-35	25-55	40-85	40-85	40-105	40-105
Operating pressure	bar	165	165	170	170	170	170

* Working weight includes hammer, standard tool and average mounting group, if required.



H35D S, H45D S, H55D S, H65D S Hydraulic Hammers

Dimensions

	mm	H35D S	H45D S	H55D S		H65D S	
				Flat-top	Pin-on	Flat-top	Pin-on
A		320	330	444	429	535	454
B		280	280	286	300	415	300
C		621	713	827	997	895	1055
D		40	48	56	56	65	65
E		221	233	298	299	330	330

Hydraulic Requirements

Combined tool control, one way auxiliary lines.

H35D S, H45D S, H55D S, H65D S
Flat-top

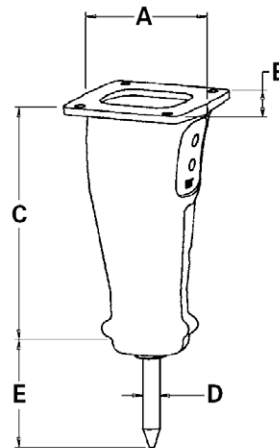

H55D S, H65D S
Pin-On

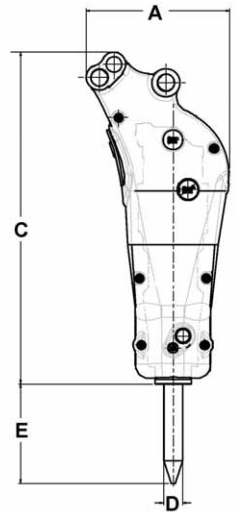

Matching Guide

Hammer	Mini Excavators
H35D S	301.6C, 301.8C
H45D S	301.6C, 301.8C, 302.5C
H55D S	302.5C, 303C CR, 304C CR, 305C CR
H65D S Pin-On	303C CR*, 304C CR, 305C CR
H65D S Flat-Top	304C CR, 305C CR, 307D, 308D CR

* Installation of add-on optional, counterweight to machine is required.